

The Toronto Eaton Centre
250 Yonge

Suite 2601

9,853 sq.ft.

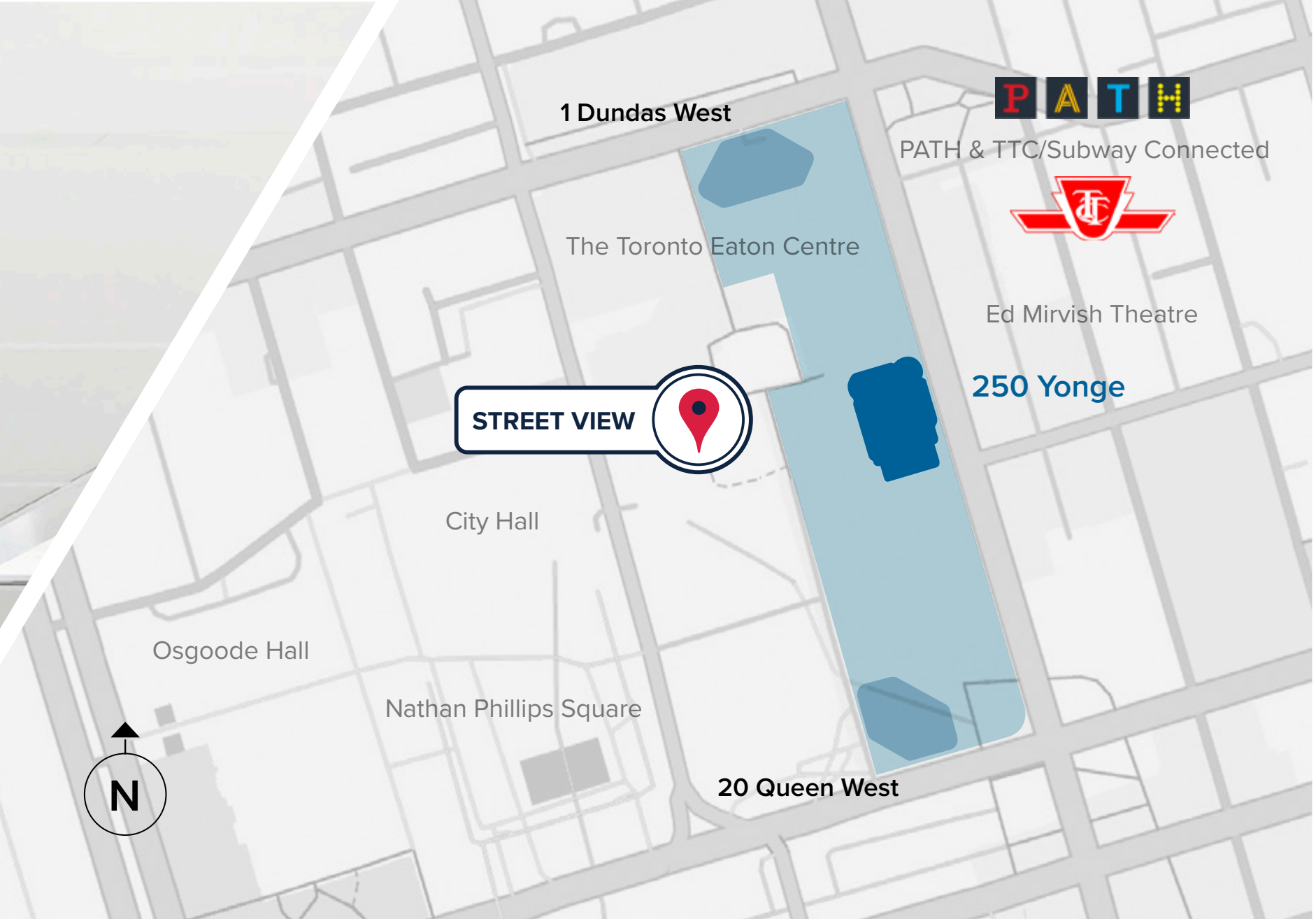

CF | Meet you there

Lawrence Barrett
Senior Director, Leasing

(416) 400-0225
lawrence.barrett@cadillacfairview.com

The Toronto Eaton Centre

250 Yonge

Suite 2601

9,853 sq.ft.

Suite 2601 is a premium office space designed to impress, featuring elevator exposure, spectacular urban views and abundant natural light throughout. A dynamic colour scheme creates a modern and vibrant atmosphere, complemented by sleek glass-enclosed offices and conference rooms for a professional and contemporary feel.

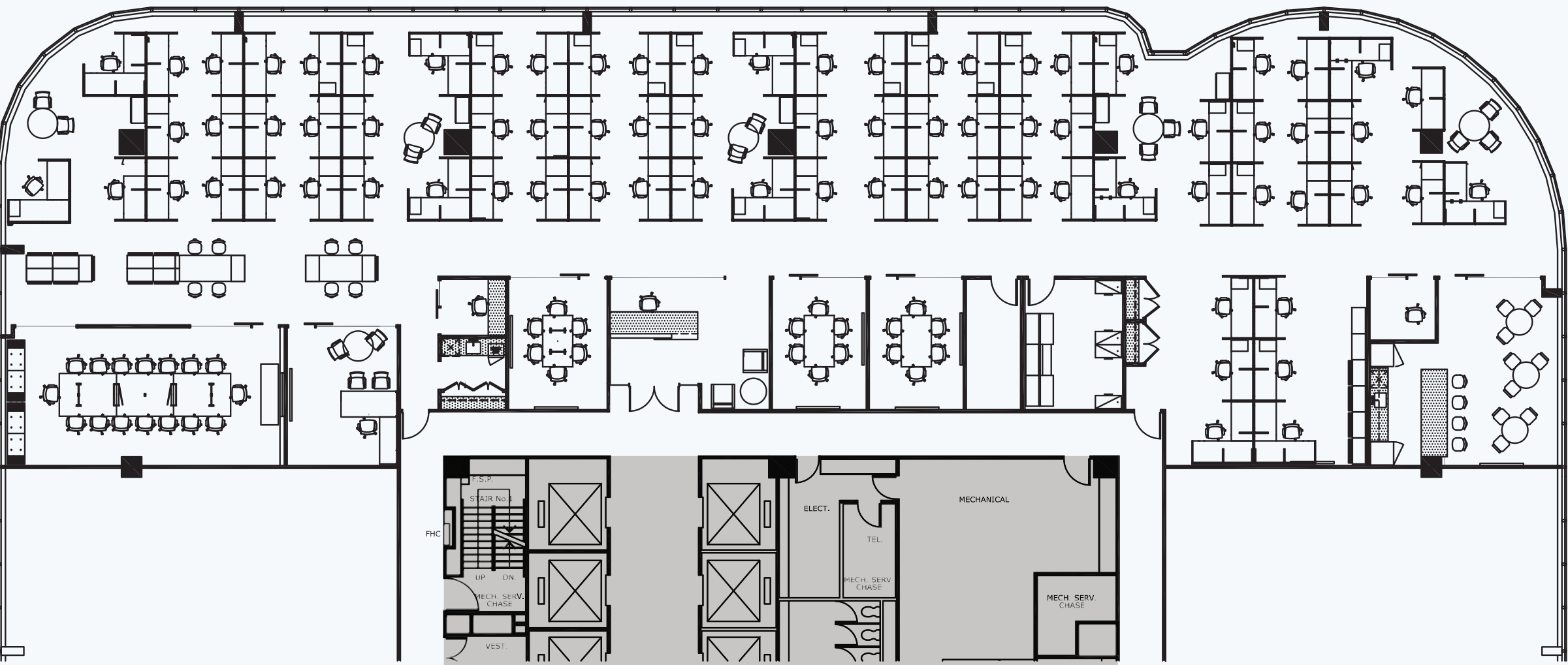

Net Rent: Starting at \$27.50 sq.ft.
Net & Additional Rent: (2025 Estimates)
Realty Taxes: \$8.10 sq.ft.
Operating Costs: \$17.90 sq.ft.
Utilities: \$1.30 sq.ft.
Unreserved Parking: \$367.25 per month/permit
Reserved Parking: \$474.60 per month/permit
(*HST included)

Total Square Feet of Space

714,000 sq. ft.

Typical Floor Size

23,000 sq. ft.

Number of Floors

35

A Dynamic Destination

250 Yonge stands in the heart of downtown Toronto, atop CF Toronto Eaton Centre, the city's premier shopping destination. This 35-storey tower boasts 23,000-square-foot open floor plates, state-of-the-art technology, abundant natural light, and exceptional finishes. It's where Toronto's vibrant business and cultural communities all come together.

PATH

[View all available vacancies](#)

- ★ Direct PATH and subway access with a Transit Score of 100 and Walk Score of 97

★ Highly accessible for drivers, cyclists, transit users and pedestrians

★ First class property management services
- ★ Direct access to world-class retail, restaurants and entertainment

★ Close proximity to hotels, meeting facilities, and event spaces

★ Convenient on-site childcare facility

WELL
Health-Safety
Rating 2024

LEED
EB:O&M
Gold 2023

BOMA
BEST
Gold 2022

RICK HANSEN
FOUNDATION
Accessibility 2022



CF | Meet you there

Lawrence Barrett
Senior Director, Leasing

(416) 400-0225
lawrence.barrett@cadillacfairview.com